

BUSCH ADDITION (DIVISIONS 1 & 2)
 SEC. 15, 16 & 21 TWP. 21 N. RGE. 1 E.

GENERAL NOTE: ALL CATCH BASIN GRATES TO BE SIDE (THROUGH CURB) FRAMES AND GRATES.

APPROVED: FOR REVISED PRIVATE STORM DRAINAGE
Richard J. Anderson 3-29-85
 PUBLIC WORKS DIRECTOR DATE

APPROVED: FOR PRIVATE STORM DRAINAGE AND ACCESS ONLY
Richard J. Anderson 9-12-81
 PUBLIC WORKS DIRECTOR DATE

CURVE NO.	RADIUS	LENGTH	DELTA
1	25.00'	23.48'	53° 48' 14"
2	38.50'	116.20'	172° 22' 27"
3	38.50'	76.74'	114° 14' 01"
4	25.00'	23.48'	53° 48' 14"

CURVE NO.	RADIUS	LENGTH	DELTA
1	25.00'	23.48'	53° 48' 14"
2	38.50'	116.20'	172° 22' 27"
3	38.50'	76.74'	114° 14' 01"
4	25.00'	23.48'	53° 48' 14"

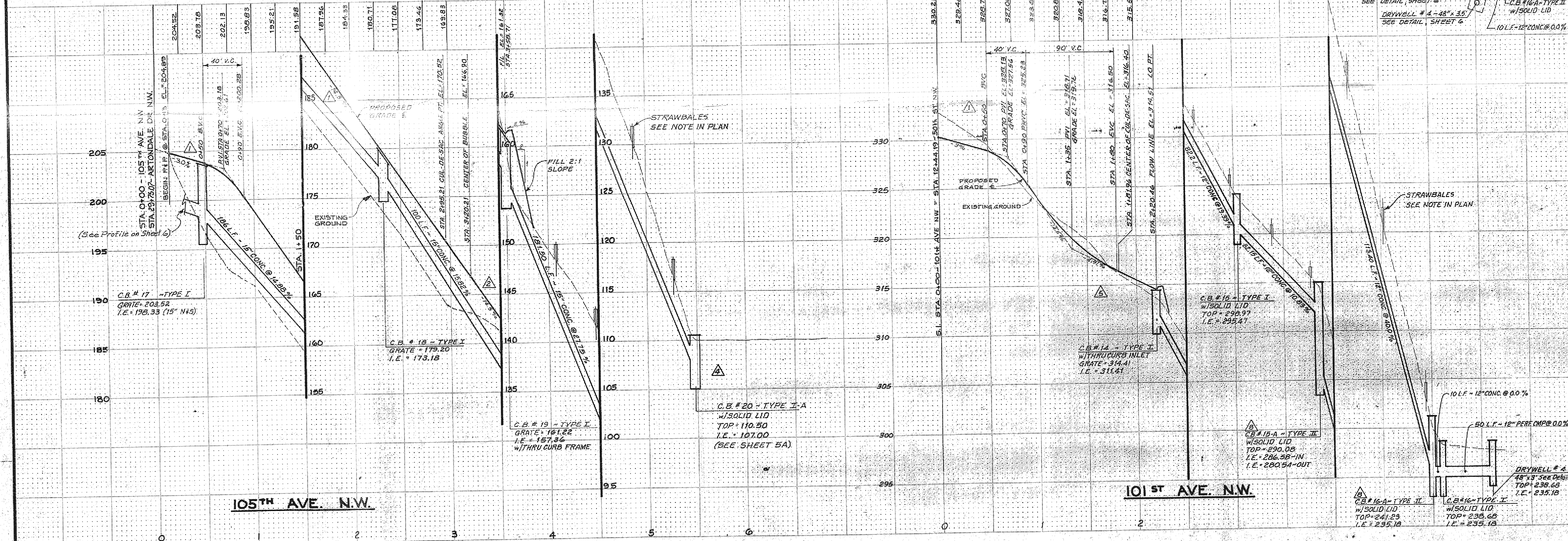
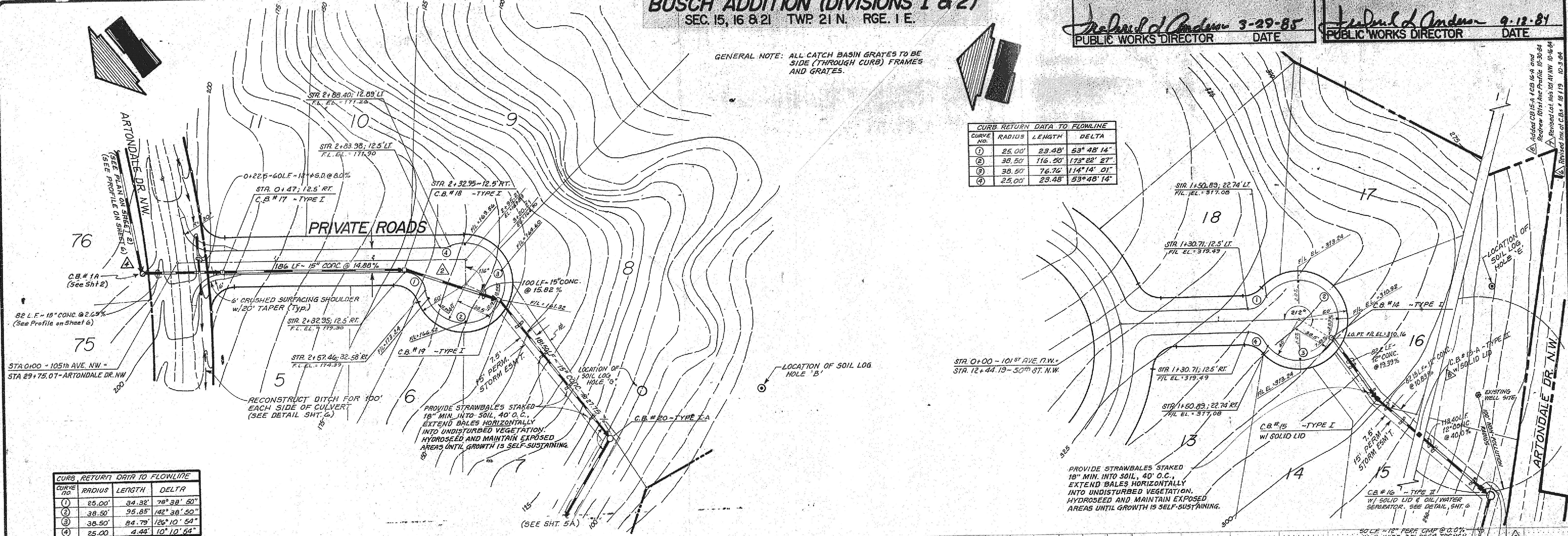

APPROVED: FOR PRIVATE STORM DRAINAGE AND ACCESS ONLY
 PUBLIC WORKS DIRECTOR DATE



BUSCH ADDITION
PAVING & DRAINAGE PLAN & PROFILE
CITIZENS SERVICE CORP.
 BOTHELL, WASHINGTON

STEPAN & ASSOCIATES, Inc.
 Engineering, Planning, Surveying
 10000 1st Avenue, Suite A, Federal Way, Washington 98003
 Telephone: (206) 875-1111

SHEET
3 of 6
 JOB NO. 4602100