

BUSCH ADDITION (DIVISIONS 1 & 2)
 SEC. 15, 16 & 21 TWP. 21 N. RGE. 1 E.

GENERAL NOTE: ALL CATCH BASIN GRATES TO BE SIDE (THROUGH CURB) FRAMES AND GRATES.

APPROVED: FOR REVISED PRIVATE STORM DRAINAGE
Paul David Anderson 9-29-85
 PUBLIC WORKS DIRECTOR DATE

APPROVED: FOR PRIVATE STORM DRAINAGE AND ACCESS ONLY
Paul David Anderson 9-19-84
 PUBLIC WORKS DIRECTOR DATE

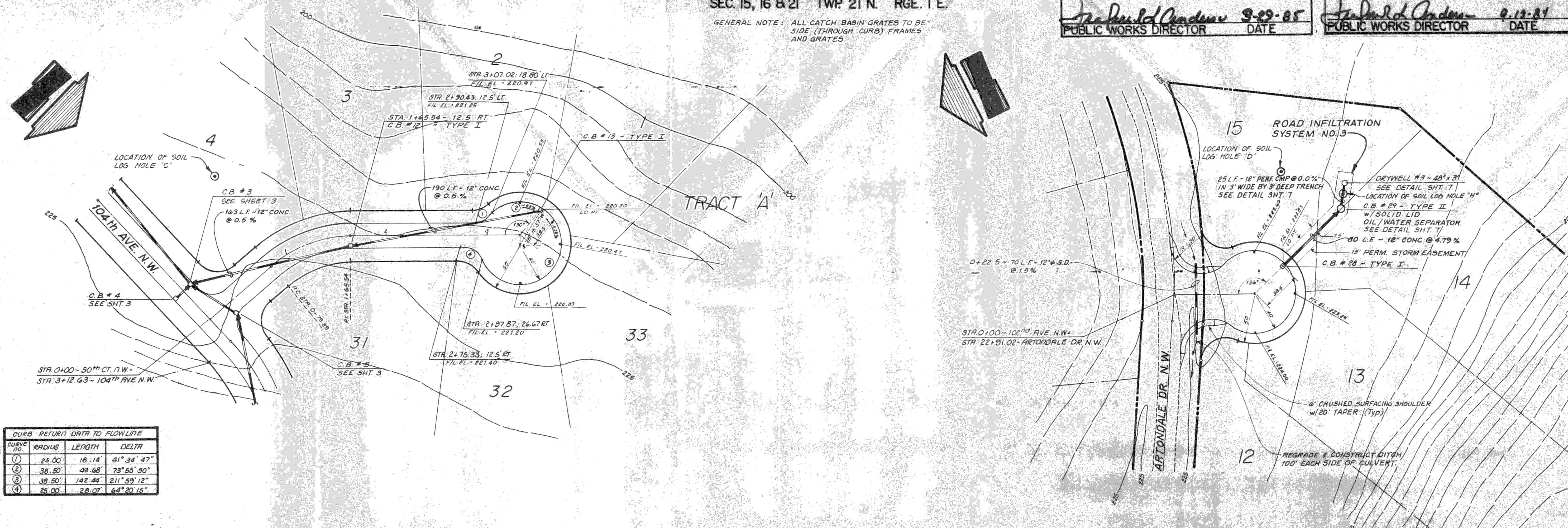

CURVE NO.	RADIUS	LENGTH	DELTA
1	25.00'	18.14'	41° 34' 47"
2	38.50'	49.68'	73° 55' 40"
3	38.50'	142.44'	211° 59' 12"
4	25.00'	28.07'	64° 20' 16"

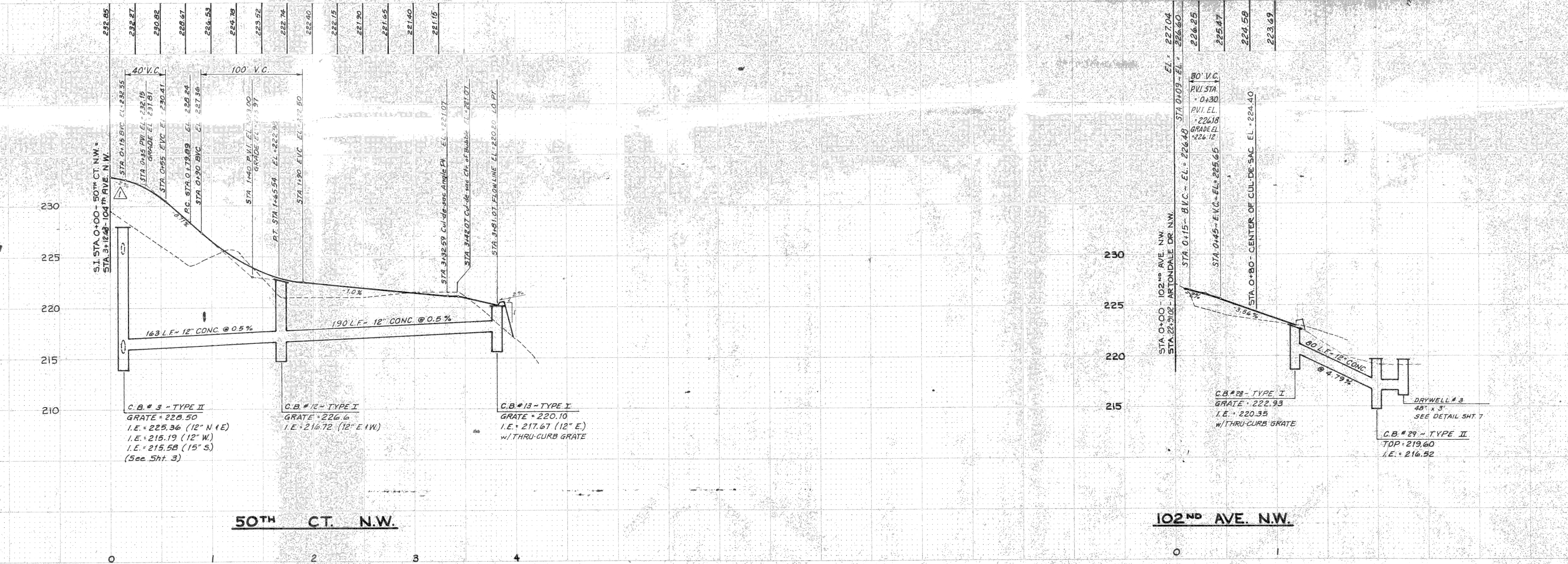

REVISIONS
 Revised Lot Nos. 50th Ct. N.W. 10/16/84
 Revised Grade 50th Ct. N.W. 9/24/84
 DESIGN: CHECKED: DATE: 4-84
 DRAWN: SCALE: H. 1" = 50', V. 1" = 5'



BUSCH ADDITION
PAVING & DRAINAGE PLAN & PROFILE
CITIZENS SERVICE CORP.
 BOTHELL, WASHINGTON

STEPAN & ASSOCIATES, Inc.
 Engineering, Planning, Surveying
 930 So. 136th Street, Suite A, Federal Way, Washington 98003
 Telephone: Tacoma 927-7850, Seattle 665-4771